

LAVENHAM

SOLAR GARDEN LIGHTS - SET OF 4

USER MANUAL



 **solarcentre**[®]
solar lighting that works

SETUP



- ① Gently remove the light unit from the lamp shade.
- ② Peel of the film off the solar panel.
- ③ Slide the switch into the 'on' position.

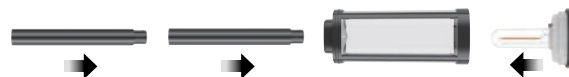

- ④ Re-insert the light unit into the lamp shade and connect both poles or use one pole if you would like the lamp to be shorter.

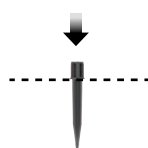

- ⑤ Check the ground to make sure the soil isn't too hard. If it is, use a metal object to create a hole or pour water in the area to soften the soil. When the ground is ready, push the stake into the ground until the collar is level with the ground leaving roughly an inch above ground.

- ⑥ Push the assembled light onto the stake. The installation is now complete. You can test the light by covering the solar panel completely - or wait until dark.



SPECIFICATIONS

| | |
|-------------------------|-----------------------------|
| Material | ABS Plastic |
| Size | 2.95 in x 2.95 in x 24.6 in |
| Power Source | 100% Solar Powered |
| Battery | 1x1.2V AA Ni-MH |
| Water Resistance | IP65 |

LAVENHAM SOLAR GARDEN LIGHTS - 4 PACK
MODEL NUMBER: SC2353
SOLARCENRE®
44-46 COLDHARBOUR LANE
HARPENDEN
HERTFORDSHIRE
AL5 4UN
WWW.SOLARCENRE.CO.UK



INVENTORY



LAMP SHADE X4



LIGHT UNIT X4



POLES X8



STAKE X4



INSTRUCTIONS

PARTS

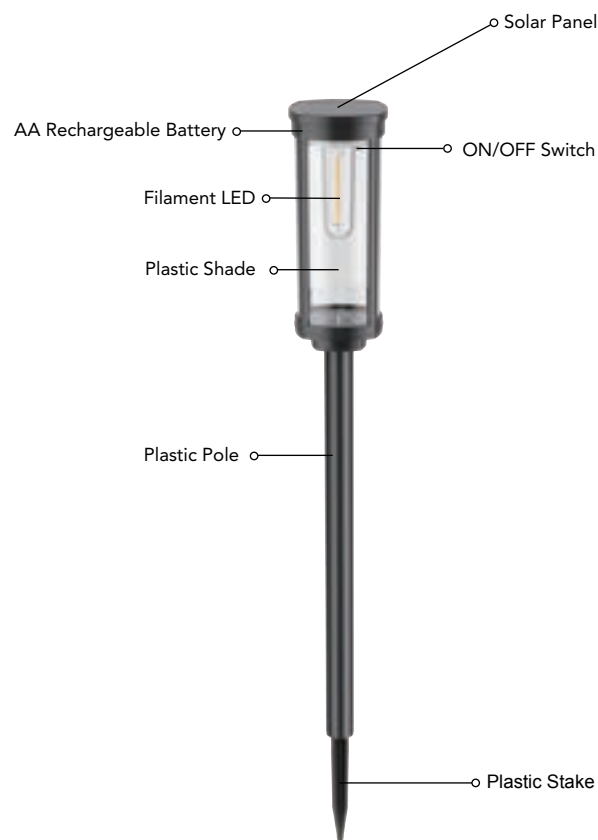

TROUBLESHOOTING



"If your mobile phone doesn't work because there is no signal you don't blame the phone, you blame the location and the same should apply to solar lights."
- a SolarCentre customer.

Solar lights won't turn on when it is light!

Solar lights turn on automatically at night and off automatically when it's light. If you want to test your solar light in lit conditions, please cover the solar panel completely.

The bottom line...

Lights that only work for a short time after dark, or lights that only turn on occasionally, are rarely faulty. Our products have been designed to work year-round in the UK so long as they are in a good enough location to charge and so long as the weather isn't too dull for too long.

If you're experiencing problems, move your light(s) to the brightest spot in your garden and see how they perform after a few days. Another thing to look out for is nearby light shining close by after dark. Light coming from another outdoor light or even light coming from inside your house can be enough to stop a solar light from turning on automatically. You can test that by completely covering the solar panel to see if the light turns on.

If your light doesn't work after a few sunny days switched off in a completely unshaded spot and you have checked for nearby light interference, you may well have a fault, so please contact your retailer or contact us via www.solarcentre.co.uk.